

ASSEMBLY INSTRUCTIONS
BOSTON SQUARE DINING TABLE 100
TEAK WOOD TOP

PARTS INCLUDED

(1) TOP TEAK WOOD 40 MM

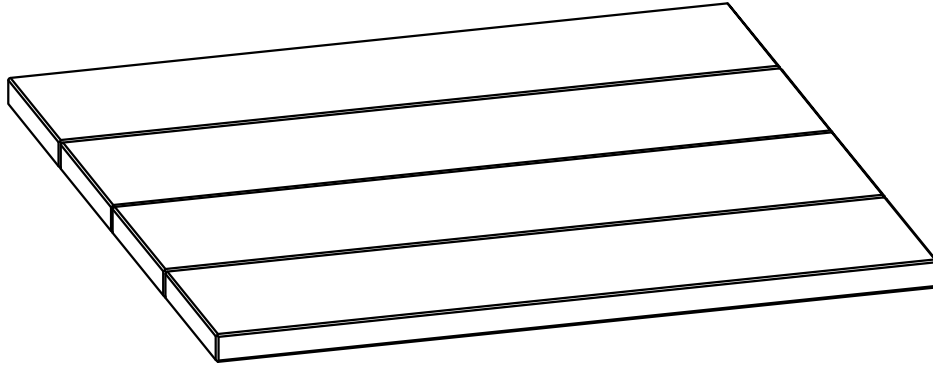

(2) SUB BASE ALLUMINIUM

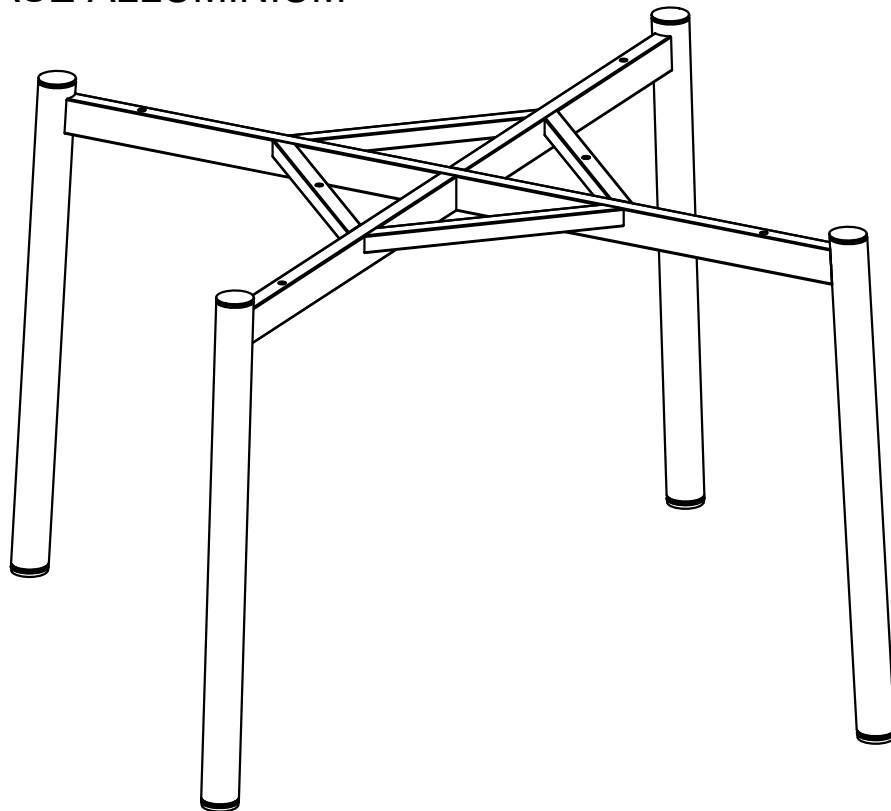

HARDWARE INCLUDED

(A) JCBC Ø8 x 70 mm4 PCS

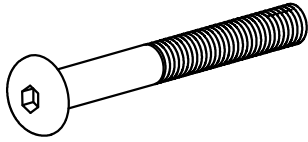

(B) JCBC Ø8 x 45 mm2 PCS

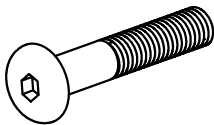

(C) ALLEN KEY 5 mm1 PC

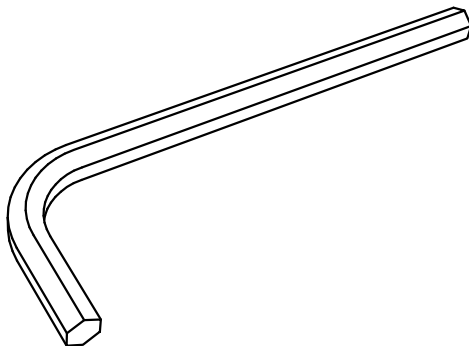

ASSEMBLY INSTRUCTIONS

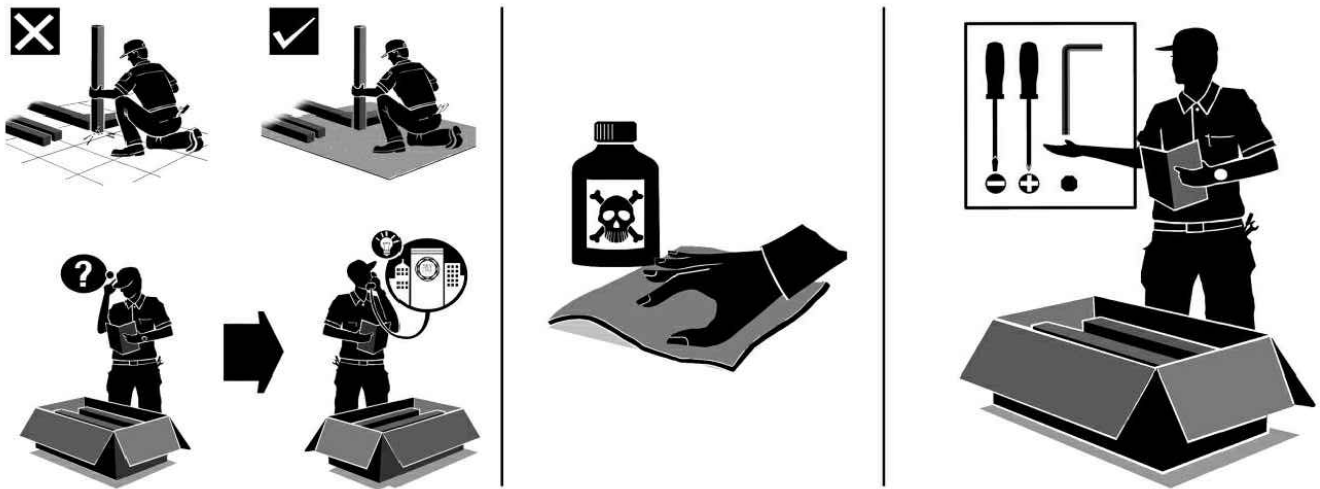

Fix the top table to the base

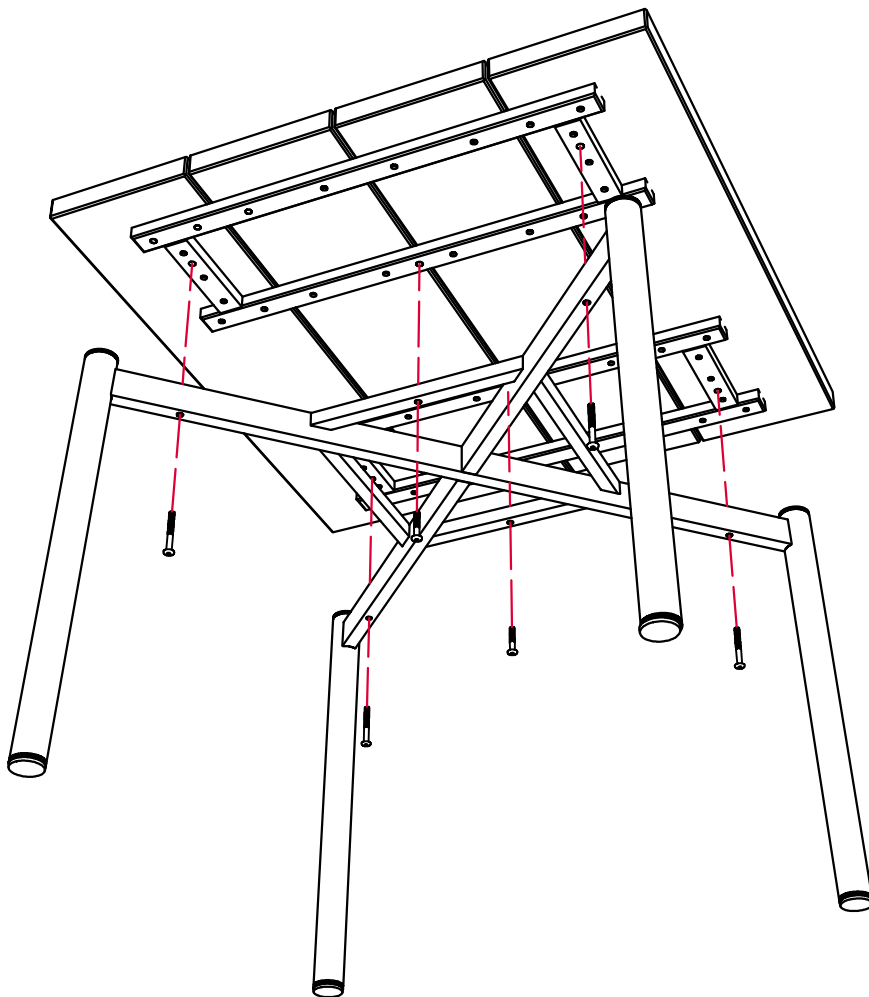

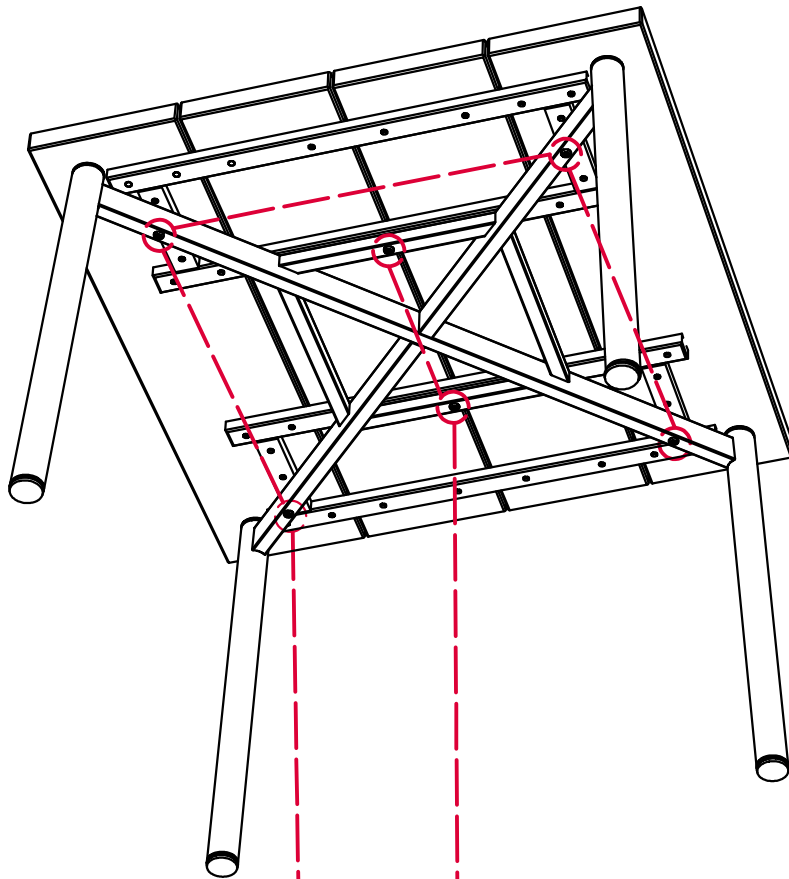

(A)
jcbc 8x70

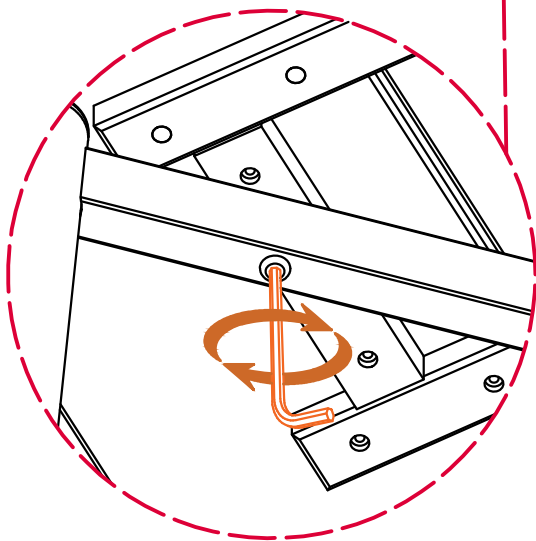

tighten by using
allen key (C)

(B)
jcbc 8x45

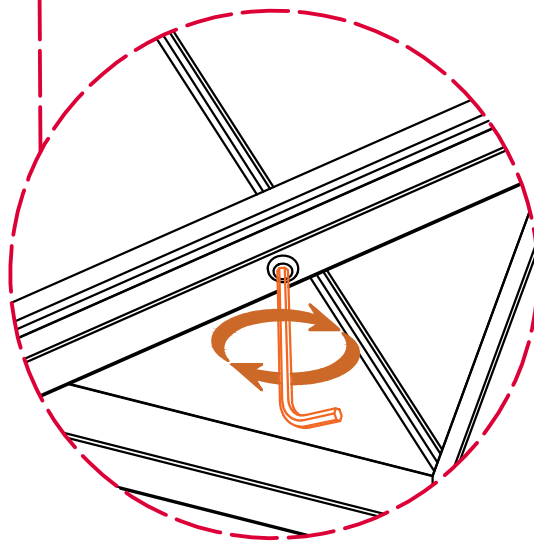

tighten by using
allen key (C)

FINISH

